

· 2015 CONFERENCE PROGRAM ·



***FORENSIC MENTAL
HEALTH ASSOCIATION:
40TH ANNIVERSARY***

40th Annual Conference
Hyatt Regency Resort & Spa
Monterey, CA ♦ March 18-20

THINGS YOU NEED TO KNOW

40TH ANNIVERSARY CELEBRATION DINNER Please use the ticket tucked in your namebadge to enter the dinner on Wednesday at 7pm and we hope you enjoy it. We have reserved a limited number of additional meals at a cost of \$70 for guests. Please see the registration table to purchase a guest ticket.

COLLEGE REGISTRATION FORM Please fill out the college registration form that was given to you when you checked in. They are submitted to the State of California who then provides funding for FMHAC, aiding us in providing the conference each year. It doesn't commit you to anything and it's an easy way for you to support FMHAC!

NOTICE BOARD It's in the exhibitor area - use it for such things as job announcements, group dinner invitations, upcoming events, or general networking!

CERTIFICATES OF ATTENDANCE Attendance certificates are included in your packet. Please review the requirements for CEUs on page 15.

ELECTRONIC EVALUATION SURVEY

The conference evaluation is electronic this year and will be emailed to you on the last day of the conference. Thank you for filling it out!

COMPLIMENTARY RESORT BENEFITS Receive these benefits when you stay at the Hyatt as an FMHAC Conference Attendee:

- › Wifi in guest rooms
- › Self & Valet Parking
- › Shoe shine
- › 10% discount at several shops as well as \$20 credit toward the coastal/nature hike at Hyatt Carmel Highlands
- › Resort & Indoor Games
- › Complimentary tennis court time
- › Wine sample at the onsite tasting room

NAME BADGES Wear your name badges throughout the conference. This will be your entrance pass to all workshops and social events. Lost badges can be replaced at the FMHAC registration table.

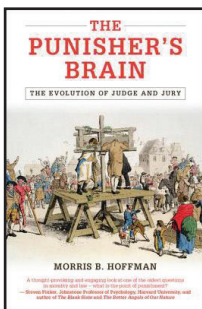

RAFFLE!

Win a signed copy of
Honorable Judge Morris Hoffmann's
book [The Punisher's Brain](#)

FMHAC Business Meeting
5pm, Thursday, March 19th
Ballroom I/II/III

TABLE OF CONTENTS

WEDNESDAY

10:00 am	Registration	3
11:00 am	Council on Mentally Ill Offenders	3
	Open Meeting	
1:00 pm	Opening Session.....	3
	• Honorable Judge Steven Leifman	
	• Anthony Ortega, LCSW	
4:00 pm	Break.....	4
5:30 pm	Reception and Poster Session.....	4
7:00 pm	40th Anniversary Celebration and Dinner.....	4
	• FMHAC Contributions over 40 Years	
	Gilbert Abdalian, MFT, MBA	
	Richard Mandella	
	David Meyer, Esq	

THURSDAY

8:30 - 10am	Breakout Session A.....	5
10:30am - Noon	Breakout Session B.....	7
Noon - 1:30pm	Lunch.....	9
1:30 - 3pm	Breakout Session C.....	9
3:30 - 5pm	Breakout Session D.....	11
5:00 pm	FMHAC Business Meeting.....	12
	• Board of Directors Elections	
	• Raffle: <u>The Punisher's Brain</u>	

FRIDAY

8:30 am - Noon	Wrap Up Session.....	13
	• Mark Willenbring, MD	
	About the Award Winners	14
	Continuing Education Information.....	15
	Meeting Room Floorplan.....	back

Letter from the President

Dear FMHAC Members,

Welcome to our 40th Annual Forensic Mental Health Association in beautiful Monterey, California. This is a historic year for our association and we developed a panel presentation to show how the association has contributed to the field of forensic mental health over the past four decades. In addition, we're having a dinner and dance for all conference attendees in celebration of our anniversary. So put on your dancing shoes and join us for an evening of fun and more fun.

For the remainder of the conference, the Planning Committee and its chairperson, Jane Lovelle, assembled presentations addressing current issues within our field. The Honorable Judge Steven Liefman has travelled from Florida to talk about his work in addressing overcrowding and poor mental health services in the Miami-Dade County Jail. His study and work in this area is innovative, heartfelt and inspiring. Dr. Mark Willenbring joins us from Minnesota to give an update on substance abuse treatment and innovations. Additionally, break-out sessions provide opportunities to learn more about sex offender treatment and assessment, mental health treatment with juvenile offenders, expert mental health testimony, suicide risk assessment and, very dear to me, artifacts from the Department of State Hospitals-Patton Museum.

I hope, along with checking your conference schedule, penciling in your selections and attending presentations, that you get a chance to enjoy the conference venue. The grounds and amenities here provide an opportunity to mingle with other attendees and establish a network of new friends and professional contacts. Having attended this conference since 1993, I have many fond memories of people I've met over the years and I especially enjoy continuing to see some of them here each year. These relationships grow stronger each year and have been of tremendous value to me both personally and professionally.

As we were planning the 40th anniversary celebration, I came across old publications from the Association which were wonderful to revisit. I found pictures of former colleagues and mentors of mine who were responsible for creating and advancing the association. It was a tremendous and successful effort from everyone in the nascent forensic mental health field of the '70's and '80's: social workers, nurses, psychiatrists, recreational therapist and administrators from jails, prisons and state hospitals. It reminded me that each and every one of us here this week is equally welcome, and in fact responsible, to keep FMHAC and our mission moving forward.

Participation in FMHAC and our mission can take many forms, including joining a committee or simply making plans to attend next year's conference. In addition, please do find the time to elect our next president and treasurer at the Business Meeting on Thursday. While I challenge you to be an active part of this association throughout the year, I also encourage you relax during this week of fun and learning. So, attend the presentations and then find opportunities to be with your colleagues, friends and new acquaintances. Come to the dinner and dance on Wednesday night and make the most of Thursday's networking lunch.

On behalf of the FMHAC Board of Directors, I thank you for your participation and contributions to the Forensic Mental Health Association of California.

Sincerely,



Munir Sewani, PhD
President
Forensic Mental Health Association of California

THANK YOU

2015 SUSTAINING MEMBERS

OF THE FORENSIC MENTAL HEALTH
ASSOCIATION OF CALIFORNIA

Gilbert Abdalian, MBA, MFT

Kenneth Carabello

Sheila Carter

Carson Chambers, PhD

Marianne Davis, PhD

Jeffery Elias, Esq

Harry Goldberg, PhD

Thomas Granucci, LCSW

Carrie Gustafson

Robert Hart, MD

Ronald Kaufman, PsyD

Samuel Knudsen, Esq

Robert Lemark, PhD

Cynthia Lermond, PsyD

David Meyer, Esq

Kelly Ross, LCSW

Armando Sandoval

Munir Sewani, PhD

Douglas Taylor Smith, LCSW

As ongoing supporters of the Association, Sustaining Members get special treatment at the conference including upgraded hotel rooms and personal thank you notes from FMHAC!

WEDNESDAY, MARCH 18

10am - 2pm

Foyer

REGISTRATION

BOOKS & FMHAC MERCHANDISE FOR SALE!

11am - 1pm

Windjammer

STATE COUNCIL ON MENTALLY ILL OFFENDERS OPEN MEETING



1pm - 4pm

Main Ballroom

OPENING SESSION (2.0 CE hrs)

- Opening Remarks and Housekeeping

Department of State Hospitals- Patton Museum: Exhibiting the Past to Strengthen Our Future

Anthony Ortega, LCSW, Supervising Social Worker, Department of State Hospitals-Patton

Since its inception, Patton has played a significant role in the development of psychiatry in California. It was the first homeopathic state hospital in the state and has always been committed to implementing state-of-the-art treatment. With a concerted effort over the past two and a half years, Patton State Hospital staff members, along with history students from California State University San Bernadino (CSUSB), have developed an on-site museum and a searchable archive database. Drawing on 124 years of history and an extensive collection of artifacts, documents and photographs, Patton's museum and archive will open this year, providing a valuable resource and unique experience to visitors. This presentation will introduce the project and include photographs of some artifacts that will be on exhibit.

CEU
CME
MCLE
POST
MCEP

Transforming Mental Health Systems – A Judicial Perspective Strategies for Planning, Leadership, Financing, and Service Development

Judge Steven Leifman, Chair, Florida Supreme Court Task Force on Substance Abuse and Mental Health Issues In the Court



It is estimated that more than two million arrests in the United States each year involve people with Serious Mental Illnesses (SMI). As a result, untrained and unprepared stakeholders in the criminal justice system have been forced to navigate an increasingly scarce system of care for people with mental illnesses. Jails have become places where a disproportionate number of people with SMI spend significant amounts of time; their ties to the community severed, their treatment needs unmet, and their illnesses made worse. Judge Leifman will discuss the legal history that led to this mental health crisis and the essential elements necessary to create an effective system of care that ultimately will transform the mental health and criminal justice systems and make jail the last option for people with serious mental illnesses, not the first.

4:00- 5:30 pm BREAK

5:30 pm RECEPTION AND POSTER PRESENTATIONS

Foyer

- Wine & Cheese

7:00 pm 40TH ANNIVERSARY DINNER

Main Ballroom

Munir Sewani, PhD, President,
Forensic Mental Health Association of California



- Awards: Christine M. West and William T. Rossiter
- FMHAC Contributions Over 40 Years
Gilbert Abdalian, MFT, MBA
Richard Mandella
David Meyer, Esq
- Music and Dancing!

POSTER PRESENTATIONS

Wine & Cheese Reception and Poster Presentations

Wednesday, March 18th, 5:30pm

Main Foyer

**Effects of Attachment,
Motivators, Type of Crime, and
Relationship to Offender on
Willingness of Third-Parties
to Provide Names to Law
Enforcement**

Amanda DeVillez, MA
Tamar Kenworthy, PsyD

**Long Term Mental Health
Effects of Solitary Confinement
on Incarcerated Youth**

Jheanett Portobanco
Gabriela Pivaral Esturban
Jessica Williams

**Legislation Affecting Forensic
Mental Health in 2015**
FMHAC Public Policy Committee

**Guidelines for Prescribing
Controlled Psychotropic
Medications to Patients with
Substance Use**

Majid Talebi, PharmD
Anthony Cozzolino, MD

**Is it Good to be Bad? The
Association of History of
Violence and Symptom Change**

Graham S. Danzer, LCSW, MRAS
Sarah M. Rieger, M.Ed

**The Use of Art Therapy to
Address Dynamic Risk Factors
with Sexual Offenders**

Amy Pfenning, ATR

THURSDAY, MARCH 19

8:30 - 10:00 am (1.5 CE hrs)

1. **Spyglass** **Child Sex Trafficking and Sexual Exploitation of Juvenile Justice and Child Welfare Youth**

CEU

CME

MCEP

Lisa Conn, MA, MFT, Supervisor, Juvenile Justice Mental Health Services, Santa Barbara
Carrick Adam, MD, Pediatrician, Santa Barbara County Juvenile Probation

This presentation will clarify the definitions of Complex Trauma, Survival Sex, Sexual Exploitation and Commercial Sexual Exploitation of Children (CSEC). Attendees will gain a deeper understanding of the prevalence and profile of sexually exploited children in our juvenile justice and child welfare systems, particularly those in foster or group home placements. The role of early childhood trauma, specifically sexual trauma experienced by girls, will be explored in relation to risk factors for future exploitation and trafficking. Tactics used by traffickers and perpetrators in the “grooming” process, as well as the challenges in helping the girls “escape” and “heal” from a life of exploitation and victimization will be outlined. We will look at the impact of addiction in CSEC, explore the need for more innovative treatment options like “harm/risk reduction”, the biopsychosocial recovery model and review new prescriptions and alternative medications and supplements in addiction treatment.

2. **Cypress** **Improving Suicide Risk Assessment wth Offenders: Collaboration and Research to Inform Practice in CDCR and DSH**

CEU

CME

MCEP

Robert Horon, PhD, Senior Psychologist, Supervisor, Director of Psychology Training Programs, Department of State Hospitals - Vacaville

Robert Canning, PhD, Senior Psychologist, Specialist, Suicide Prevention Coordinator, Statewide Mental Health Program, CA Department of Corrections and Rehabilitation

Todd McManus, PhD, Staff Psychologist/Research Coordinator, Department of State Hospitals - Vacaville

Two agencies, the Department of State Hospitals (DSH) and California Department of Corrections and Rehabilitation (CDCR), are collaborating on efforts to reduce the frequency of suicides that occur within California prisons. These efforts include sharing clinical approaches, conducting formal research related to suicide risk assessment with violent offenders, collecting evidence from psychological autopsies, and sharing key risk management information when inmates move between agencies. The presentation will discuss key findings in three areas: Correctional-specific risk factors, the integration of suicide risk assessment measures as part of correctional suicide risk evaluations, and the use of a structured professional judgment approach to derive risk assessment and risk management conclusions.

- 3. Ballroom** **Unraveling the Mysteries of Criminal Responsibility**
IV/V/VI Honorable Judge Morris Hoffman, Second Judicial District, Denver, Colorado
 CEU
 CME
 MCEP
 MCLE
 POST
 In this presentation, we will discuss some of the recent behavioral and neuroscience literature that is starting to shed light both on what it means for a criminal defendant to act with one of the four mental states recognized by the Model Penal Code (purposeful, knowing, reckless and negligent). Judge Hoffman will discuss what it means when jurors or other third-parties reach conclusions about a defendant's mental state and the implications this research may have on the criminal justice system in general and in the areas of addiction and intoxication in particular.
- 4. Big Sur** **The Psychoanalytic Bridge Between Psychology and the Law in SVP Evaluations: Assessing Emotional and Volitional Impairment**
 CEU Eric Simon, PhD, ABPP, SVP Evaluator, California Department of State
 CME Hospitals Sex Offender Commitment Program
 MCEP
 MCLE
 The legal concepts of emotional and volitional impairment in Sexually Violent Predator (SVP) evaluations are vague and ill-defined. This presentation provides a rather thorough review of the legal terms of emotional and volitional impairment as they have been contemplated in the extant SVP statutes, SVP case law, logical constructions, and the limited empirical studies. To bridge the gap between psychology and the law, a broad, theory-based heuristic framework is furnished for understanding emotional and volitional impairment at a depth, psychological (and intra-psychic) level. Specifically discussed are the concepts of transference, repetition compulsion, fixation, cathexis, regression, identification with the aggressor, and the object-relations and self-psychology concepts related to a loss of possession of the self.
- 5. Ballroom** **Mindfulness-Based Substance Abuse Treatment for Incarcerated Youth and Young Adults**
I/II/III Sam Himelstein, PhD, Founder, Lion Mind Counseling
 CEU
 CME
 MCEP
 Mindfulness as an intervention has been growing drastically over the past two decades. Mindfulness has been researched with numerous populations, and recently a growing number of publications have investigated its impact both on youth and substance abuse treatment. This workshop will review the critical therapist/facilitator qualities necessary for building authentic relationships with incarcerated youth/young adults that build the foundation for substance abuse/addiction treatment. A conceptual framework for why mindfulness is a critical skill in reducing relapse and preventing incarceration will be presented, alongside practical techniques and interventions for how to engage this population in effective, evidence-based substance abuse treatment. Segments of an innovative mindfulness-based substance abuse treatment curriculum will be presented in addition to real case examples from the presenter's experience. This workshop will utilize mainly a didactic approach, but also include experiential activities and will have a dedicated time for a Q&A at the end of the session.

Meeting Room map on back cover

10:00 am COFFEE BREAK

10:30 - Noon (1.5 CE hrs)

1. Spyglass Motivational Interviewing with Involuntary Clients

CEU

CME

MCEP

Jennifer Baity, LCSW, LAADC, MHRC Program Director, San Francisco General Hospital

Motivational Interviewing (MI) is a well-known evidence-based practice. It is a form of collaborative conversation for strengthening a person's own motivation and commitment to change that focuses on the language of change and explores a person's ambivalence about change. Forensic clients are often wrongly thought of as "unchangeable" and impervious to clinical interventions that address some of the common issues they face that have often led to their incarceration such as excessive substance use, poor psychiatric medication adherence, anger management problems, and the like. In this presentation, learn more about MI and why it is more likely to keep your clients from ending up back in the system than many other approaches.

MORE ABOUT: MOTIVATIONAL INTERVIEWING

Article Abstract, Legal and Criminal Psychology

Motivational Interviewing with Offenders: A Systematic Review

Professor Mary McMurren

Purpose. Offender motivation is one specific responsivity variable in offender treatment and motivational interviewing (MI) is commonly used by corrections personnel. Although evidence for the effectiveness of motivational interviewing is accruing overall, a review of MI specifically with offender populations is required.

Method. Relevant databases and websites were searched using terms relating to MI with offenders.

Results. In total, 13 published studies and 6 dissertation abstracts were identified. MI is most evaluated in relation to substance misusing offenders (N=10). Other applications are with domestic violence offenders (N=3), drink-drivers (N=5), and general offending (N=1). In these populations, MI is used to enhance retention and engagement in treatment, improve motivation for change, and change behaviour.

Conclusions. MI can lead to improved retention in treatment, enhanced motivation to change, and reduced offending, although there are variations across studies. To advance the study of MI with offenders, a theory of change needs to be articulated on which testable hypotheses may be based. The integrity of treatment in its application needs to be assured. Based on these foundations, more outcome research is needed to examine who responds to what type of MI in relation to treatment retention, readiness to change, and reconviction.

Meeting Room map on back cover

- 2. Ballroom** **Blame in Criminal Misconduct**
I/II/III David Naimark, MD, Supervising Psychiatrist, Adult Forensics, Health and
CEU Human Services Agency, County of San Diego; Clinical Professor, Department
CME of Psychiatry, University of California, San Diego
MCEP Brian Benjamin, MS IV, 4th Year Medical Student, Western University of Health
MCLE Sciences
- This presentation will discuss a new theory of blame in criminal misconduct. The concept of “theory of mind” involves the ability to understand and perceive that other people’s thoughts, feelings, desires, etc., are different and separate from one’s own thoughts, feelings, desires, etc. There is an emerging literature showing that certain individuals (autistic, schizophrenic, etc.) lack a fully developed theory of mind. Such social deficits may make it difficult for an individual to properly read, understand, and respond to social cues. If a crime is committed as the result of such social deficits, an individual may be considered less blameworthy of the crime committed. For example, compare an autistic man who misreads social cues and gropes a woman, with a sociopath who stands in the subway and gropes women. The autistic man has misread social cues, whereas the sociopath simply lacks empathy. This presentation will explore the idea that these two acts are not equally blameworthy, and that theory of mind deficits should be accounted for in the assessment of blame.
- 3. Ballroom** **Legal Foundations For Mental Health Testimony: Updating Your**
IV/V/VI **Understanding of the Courtroom’s Legal Requirements for the**
CEU **Presentation of Mental Health Evidence in California State and**
CME **Federal Courts**
MCEP John T. Philipsborn, JD, M. Ed, Attorney, Private Practice
MCLE
- This presentation is intended to provide you with tools to present mental health testimony that addresses and conforms to the legal tests for the admission of expert testimony, and it will address a number of issues that have arisen in recent cases.
- 4. Big Sur** **Paraphilic Disorders in DSM-5**
CEU Richard Krueger, MD, Associate Clinical Professor of Psychiatry, Columbia
CME University, College of Physicians and Surgeons
MCEP
- This presentation will review the paraphilic disorders in the Diagnostic and Statistical Manual, 5th Edition, of the American Psychiatric Association (DSM-5), discuss the controversies regarding paraphilic diagnoses and include specifically the diagnoses of hypersexual disorder and compulsive sexual behavior disorder.
- 5. Cypress** **Practical Assessment and Treatment Methods for Prosocial**
CEU **Reasoning for Probation Youth**
CME Norbert Ralph, PhD, MPH, Neuropsychologist and Epidemiologist
MCEP
- This workshop will present research regarding the relationship of prosocial reasoning in juveniles to criminal outcomes. Practical assessment and treatment techniques regarding prosocial reasoning will also be presented relevant to the general probation population.

12:00 noon LUNCHEON

Vegetarian lasagne is one of the buffet options. Please discuss other meal needs with the banquet wait staff at the luncheon.

1:30 - 3:00 pm (1.5 CE hrs)

1. Ballroom I/II/III Computer Forensics - Learning from Bytes Taken Out of Crime: Prevention, Treatment and Assessment Utilizing Digital Discovery

CEU

Glenn Scott Lipson, PhD, ABPP, Program Director and Professor, California School of Forensic Studies/Alliant International University

CME

MCEP

Frederick Lane, JD, Computer Forensics Expert Consultant and Author

MCLE

Randy Ellen Kasper, LCSW, Private Practice

POST

Whether engaged in threat assessment or treatment, the advent of the digital self as an aspect of who we are needs to be evaluated. Avatars people complete online have become part of the mix that shape and influence our choices as well as the healthy or dangerous expressions of our desires. Suicide notes now reside within smart phones and bullying and homicidal plans in digital or cloud-based media. This panel brings together a computer forensics and privacy expert, a forensic psychologist who utilizes and also seeks forensic discovery for his assessments, and a social worker who teaches and works in a hospital setting and private practice to discuss this new frontier. How will we interpret this forensic computer data, how is it accessed and what are the implications for the practice of law and mental health in the future?

2. Spyglass Life After Life: HealthRIGHT360's Experience With Clients Released From Custody After Up to 50 Years of Incarceration

CEU

Wayne Garcia, Vice President of Programs, HealthRIGHT360

CME

MCEP

Scott Collier, MSW, PhD, Director of Research and Evaluation, HealthRIGHT360

Gavriel Mardell, PsyD, Vice President of Mental Health Services, HealthRIGHT360

HealthRIGHT 360 has worked with hundreds of individuals who have been released from custody after being sentenced to life in prison and having served decades behind bars. More than 50% of HealthRIGHT 360's residential treatment facility in Los Angeles is now comprised of former "lifers". These individuals have had a unique impact on the treatment milieu and have specific needs and challenges. This presentation will focus on the treatment and re-socialization needs of this group of clients and the life skills that generally need strengthening upon release from ten, twenty, or even fifty years in prison. Many former "lifers" also have age related health concerns. Whether it is chronic illness and pain or re-integrating to a society that seems as though it has left them behind, former "lifers" provide treatment opportunities and challenges with which the field must be prepared to work.

Meeting Room map on back cover

- 3. Ballroom IV/V/VI**
Juvenile Misbehavior as a Public Health Issue: The Link Between Adverse Childhood Experiences and Delinquency
 CEU
 MCEP
 MCLE
 Marian Gaston, JD, Deputy Public Defender, San Diego County
 The link between traumatic Adverse Childhood Experiences (ACEs) and poor health outcomes later in life is well established. This lecture addresses a study of 100 juveniles detained in the San Diego County Juvenile Hall, and the connection between ACEs and the behaviors which resulted in their involvement in the juvenile justice system. This presentation also asks whether some “delinquent” behaviors might better be viewed as public health problems, rather than criminal activities.
- 4. Big Sur**
 CEU
 CME
 MCEP
Paraphilic Disorders in ICD-11
 Richard Krueger, MD, Associate Clinical Professor of Psychiatry, Columbia University, College of Physicians and Surgeons
 This presentation will discuss the current proposed definitions of paraphilic disorders for the International Classification of Disease, 11th Edition, (ICD-11) which will be of growing importance and controversies regarding paraphilic diagnoses in this classification system will be reviewed.
- 5. Cypress**
 CEU
 CME
 MCEP
‘Just Get Over It’ Just Isn’t Enough: Toward a Conceptual Framework for Trauma-Informed Care
 Alicia Summers, PhD, Program Director, Research & Evaluation, National Council of Juvenile and Family Court Judges
 This presentation will describe the efforts of the National Council of Juvenile and Family Court Judges to define and operationalize what it means to be a trauma-responsive court and to develop a protocol for conducting “trauma audits” in courts to assess the degree to which environment, practice, and policy are trauma-responsive. Included in the presentation will be an overview of trauma and how it may affect the children and families who come before the juvenile and family courts, as well as preliminary findings and the lessons learned from the first eleven trauma audits.

EXHIBITORS

Janssen Systems of Care

MHM Services, Inc.

Psychological Assessment Resources, Inc. (PAR)

UC Davis Jail Psychiatric Services

Otsuka Pharmaceuticals

Janssen Pharmaceuticals

3:00 pm COFFEE BREAK

3:30 - 5:00 pm (1.5 CE hrs)

- 1. Ballroom I/II/III Enhanced Treatment Unit: A Successful Intervention for Violent Inpatients**
CEU Marie Cugini Schur, PhD, Senior Psychologist Supervisor, Department of State Hospitals - Atascadero
CME
MCEP

The Department of State Hospitals-Atascadero (DSH-A) has developed a successful pilot program to reduce violence called the Enhanced Treatment Unit (ETU). The ETU accepts and treats some of the most violent patients in the State Hospital system. Patients targeted for this intervention have a severe mental illness that has not responded to standard treatment and are acutely dangerous. The culture of the unit, the nuts and bolts of operation, unit therapy interventions, and admission and transition procedures will be described. Results from the ETU show that 80% of patients who have participated in this program are less psychiatrically symptomatic and maintain their reduction of violence up to nine months after discharge. Other hospitals are beginning to consider this model for their institutions, and there is currently pending legislation proposing placement of an ETU in every State Hospital based on the DSH-A model. This presentation will include elements crucial to the success of pilot programs as well as challenges and limitations of specialized units.

- 2. Spyglass Whole Community Solutions for Mental Health Crisis**
CEU Mark Anderson, MA, Executive Director, Barbara Schneider Foundation
CME
MCEP
POST

The mental health system is a local system made up of a variety of public, private and community partners. Who are they, how do they work, how can they work more effectively together? What is crisis from the point of view of the person in crisis and how does it develop? How can we better understand the crisis by understanding the whole person? How can we resolve nearly all crisis situations without using force, seclusion, or restraints? This presentation will discuss these questions and more, including how de-escalation is applied in a wide variety of settings with many different professions working in many different systems and how can it help keep you safe and improve outcomes in your setting.

- 3. Ballroom IV/V/VI A Defense Attorney's Perspective of MDO and NGI Cases: Expert Witnesses, Cross Examination, Ethical Duties and Juror Response**
CEU Frank Birchak, Esq, Deputy Public Defender, San Diego Public Defender's Office
MCEP
MCLE

This presentation is an examination of recommitment proceedings of Mentally Disordered Offender (MDO) and Not Guilty by Reason of Insanity (NGI) cases from a defense perspective. Mr. Birchak will examine the general processes and legal standards for the hearings, the rights of defendants at the recommitment hearings, differences between the two types of recommitments, ethical duties of counsel and experts in these proceedings, common evidentiary and pre-trial motions, and areas and theories of defense attacks on expert opinions in support of recommitment.

Meeting Room map on back cover

4. **Big Sur**
CEU
CME
MCEP

The Role of Androgen Reduction Therapy for the Treatment of Individuals Who Have Committed Sexual Offenses

Richard Krueger, MD, Associate Clinical Professor of Psychiatry, Columbia University, College of Physicians and Surgeons

This presentation will discuss androgen reduction therapy as a treatment for individuals with paraphilic and/or hypersexual disorders or individuals who have committed sexual crimes, with a review of the biological and clinical basis for such therapy, the current state of use of such therapy, ethical considerations involved in administering such therapy, and details of how such therapy is administered.

5. **Cypress**
CEU
CME
MCEP

A Social-Ecological Approach to Community Trauma and Optimal Wellness: Practical Tools to Heal from Complex Trauma for Youth and Young Adults

Fidel T. Rodriguez, Omo Awo, Mind-Body-Spirit Human Relations and Violence Prevention Specialist, Los Angeles County Human Relations Commission

Robert Hernandez, MSW, Adjunct Assistant Professor, School of Social Work, University of Southern California

This workshop will provide participants with an overview of working with vulnerable youth and young adult populations impacted by high rates of community trauma. Ethno-historical and structural dynamics will be explored in group discussions. In the latter half of the workshop, an overview of practical tools for wellness used with “at risk” and formerly incarcerated youth will be presented in a cultural context. The workshop also conveys the significance of developing a personal practice of mind, body and spiritual discipline in developing grit, character and beginning stages of a paradigm shift and healing process from complex trauma. A physical exercise activity and meditation will be offered for participants to experience.

5:00 pm
Ballroom
I/II/III



ANNUAL FMHAC BUSINESS MEETING

Non-members are encouraged to attend but only current members may vote.

- Board of Directors Elections:
President-Elect, Vice President, Treasurer

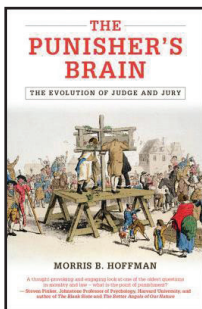

RAFFLE!

**Win a signed copy of Honorable Judge
Morris Hoffmans's
book The Punisher's Brain at the
FMHAC Business Meeting**

FRIDAY, MARCH 20

Room check out at the Hyatt is 12:00 noon.

8:30am - 12noon (3.0 CE hrs)

**Main
Ballroom**
CEU
CME
MCEP
MCLE

Addiction Treatment for the 21st Century: New Findings, Epidemiology, Diagnosis

Mark Willenbring, MD, Founder and CEO,
Alltyr: Transforming Treatment for Addiction

Significant changes in the diagnosis and treatment of substance use disorders (SUDs) have occurred in recent years, and are ongoing. This presentation will present an overview of the most important new developments in our understanding of the mechanisms, natural history and epidemiology of SUDs. Changes in diagnosis with the introduction of DSM-5 will be described, as will the implications for clinicians and managers. Treatment topics include new behavioral approaches, anti-relapse medications, chronic care management and treatment of co-existing SUD and mental health and physical disorders, especially as they apply to people involved with the justice system. Finally a completely new conceptual framework for how identification, assessment and treatment services should be deployed will be described. The emphasis will be on practical, cost effective approaches, mainstreaming SUD services across the health, social and justice systems, and integration of care across time and facilities.



Words to Deeds, A Project of FMHAC

Changing the Paradigm for Criminal Justice and Mental Health

Since 2003, Words to Deeds has provided a unique forum that has evolved into a standard best practice for creating a true shift in the paradigm between criminal justice and mental health by fostering successful and ongoing collaboration among courts, criminal justice agencies, mental health professions, and governmental and nongovernmental organizations.



Supported by Lilly USA, Janssen, Otsuka, the California HealthCare Foundation, the California State Association of Counties, and the California State Sheriff's Association.

Remember to complete the Electronic Evaluation Survey!

CONGRATULATIONS!

2015 AWARD WINNERS

WILLIAM T. ROSSITER AWARD

The Judicial Council of California

Since 2008, the Judicial Council of California's Task Force for Criminal Justice Collaboration on Mental Health Issues (2008-2011) and Mental Health Issues Implementation Task Force (2012-2015) have focused on improving practices and procedures in cases involving both adult and juvenile offenders with mental illness. One hundred and thirty-seven task force recommendations from a 2011 report encompassed the entire criminal and juvenile justice continuum, from early intervention through community reentry following incarceration or detention. Subsequent implementation efforts are promoting evidence-based practices that foster the fair and efficient processing and resolution of cases involving mentally ill persons in the criminal justice system, developing mental health curriculum for judicial officers and court staff, and promoting specialized training for law enforcement and mental health service providers. The Judicial Council has placed great emphasis on encouraging collaboration among criminal justice partners and other stakeholders to facilitate interagency and interbranch efforts that reduce recidivism and promote improved access to treatment for persons with mental illness.

CHRISTINE M. WEST AWARD

John T. Philipsborn, Esq

John Philipsborn began his work in the criminal justice system more than 40 years ago in several internships with the Federal Bureau of Prisons and as a VISTA volunteer helping to develop programs to address community placement of persons convicted of felonies.

Durning his career, John has been involved in the defense in a number of notable trials and more than 30 death penalty cases, most recently the first death penalty case in the history of Hawaii since it became a state. John and his co-counsel were able to secure a life sentence for their client against a government trial team that included some of the lawyers now on the Boston bombing case. John was one of the lawyers on the West Memphis Three case, chronicled in several movies, and which garnered worldwide attention for 3 teenagers convicted of a triple murder in Arkansas but were freed in 2011. He represented American Indian activist Eddie Hatcher and has represented persons associated with the notable Chicago Seven case. More recently, he was involved in the defense of several members of the Black Panther Party who were re-charged with murder years after the fact, in a case that revisited the turbulent history of the 1960s and early 1970s and which resulted in the dismissal of charges. As Chair of the Amicus Committee of California Attorneys for Criminal Justice and in his own practice, John has also been involved in several notable US Supreme Court cases. His work figures in more than 80 published decisions of reviewing courts.

For many years, John has been interested in forensic mental health issues. He has authored dozens of book chapters and articles on forensic mental health and has lectured to FMHAC, the American Psychological Association and many groups of mental health experts and lawyers. Just in the last 8 months, he has lectured to audiences in Texas, Louisiana, Wyoming, and at several meetings in California on the intersection of the practice of forensic mental health and the law.

John has been on the faculty of the California Death Penalty Defense College since 1992, and a federal court has just appointed John and well known death penalty defender Michael Burt to defend the retrial of Vermont's first federal death penalty case.

CONTINUING EDUCATION

Find your licence type below and follow the instructions to receive CE credit. It is recommended that you use the Sign In/Out form provided in your conference packet to ensure FMHAC has a record of your session attendance.

Don't forget to be signed in and out of your sessions. DO NOT ask FMHAC to sign for a session outside the meeting rooms, after a class has started, or before a class has ended. We can't put our CE providership in jeopardy!

CEU - All Workshops Approved

BBS/BRN (MFT, LCSW, RN, NP, LVN, Psych Tech)

BBS provider #PCE 4800, BRN provider #CEP 5965

Fill out the Evaluation Survey to receive credit. Remember, the Evaluation is electronic this year and will be emailed to you on the final day of the conference.

We recommend you utilize the Sign In/Out form provided in your conference packet.

MCEP (Psychologists) - All Workshops Approved

CPA OPD provider #FOR005

Complete the following forms and turn them in at the registration table at the end of the conference to receive credit.

1. Sign In/Out form (duplicate form). One form is provided to each attendee for the entire conference. Make sure to obtain FMHAC initials at each workshop you attend and that a member of the FMHAC Board signs the form at the end of the conference. Maintain your yellow copy.
2. Fill out the Evaluation Survey to receive credit. Remember, the Evaluation is electronic this year and will be emailed to you on the final day of the conference.

CE Statement: FMHAC is approved by the California Psychological Association to provide continuing professional education for psychologists. FMHAC maintains responsibility for this program and its content.

MCLE - See Courses Marked MCLE

CA State Bar Provider #15388

Fill out the Evaluation Survey to receive credit. Remember, the Evaluation is electronic this year and will be emailed to you on the final day of the conference.

We recommend you utilize the Sign In/Out form provided in your conference packet.

Selected Sessions:

Frank Birchak, Esq

Marian Gaston, Esq

Hon. Morris Hoffman

Hon. Steven Leifman

Glenn Lipson, PhD

David Naimark, MD

John Philipsborn, Esq

Eric Simon, PhD

Mark Willenbring, MD

Remember to complete the Electronic Evaluation Survey!

POST - See Courses Marked POST

POST units have been approved for selected sessions, #2540-28000-13014. 20 hours have been approved, but with some sessions are concurrent so 14 hours are possible.

Sign the POST attendance sheet at each session to receive credit.

Selected Sessions:

Mark Anderson, MA
Hon. Morris Hoffman
Hon. Steven Leifman
Glenn Lipson, PhD

CME - See Courses Marked CME

11 CME units for selected sessions have been approved.

Complete the following forms and turn them in at the registration table at the end of the conference to receive credit.

1. Sign In/Out form (duplicate form). One form is provided to each attendee for the entire conference. Make sure to obtain FMHAC initials at each workshop you attend and that a member of the FMHAC Board signs the form at the end of the conference. Maintain your yellow copy.
2. Fill out the Evaluation Survey to receive credit. Remember, the Evaluation is electronic this year and will be emailed to you on the final day of the conference.

Selected Sessions:

Mark Anderson, MA	Hon. Morris Hoffman	John Philipsborn, Esq
Jennifer Baity, LCSW	Robert Horon, PhD	Norbert Ralph, PhD
Lisa Conn, MFT	Richard Kreuger, MD	Marie Schur, PhD
Wayne Garcia	Hon. Steven Leifman	Eric Simon, PhD
Robert Hernandez	Glenn Lipson, PhD	Alicia Summers, PhD
Sam Himelstein, PhD	David Naimark, MD	Mark Willenbring, MD

CME Statements: This activity has been planned and implemented in accordance with the Essential Areas and policies of the Institute for Medical Quality/California Medical Association (IMQ/CMA) through the joint sponsorship of SCVMC and FMHAC. The SCVMC is accredited by the Institute for Medical Quality/California Medical Association (IMQ/CMA) to provide continuing medical education for physicians. The SCVMC designates this Live Activity for a maximum of 12 AMA PRA Category 1 Credit(s). Physicians should claim only the credit commensurate with the extent of their participation in the activity. This credit may also be applied to the CMA Certification in Continuing Medical Education.

Conflict of Interest Statement: Presenters for CME courses were screened for conflicts of interest and any conflicts were resolved by review of CME activity content, e.g. slides, by the Conference Planning Committee CME Chair, who has no conflict of interest.

STC - Special Certification

Apply for Special Certification through your STC training manager/coordinator.

THANK YOU TO MHM SERVICES!

2015 GOLD CORPORATE MEMBER



MHM Services, Inc.

The Public-Private Partner for Healthcare

MHM Services, Inc. is a leading national provider of healthcare services to state and local government agencies.

MHM is proud to sponsor the 2015 Forensic Mental Health Association of California conference in Monterey, CA.



Deb Crook, MS

Regional Vice President of Operations
Over 10 years with MHM

MHM boasts over 30 years of experience in providing contractual behavioral health management services in a wide range of patient care settings including hospitals, nursing homes, correctional facilities, and community mental health centers. In California, MHM manages eight CON-REP program regions and provides staffing assistance for Coalinga and Atascadero state hospitals. MHM employs over 3,000 clinical, managerial and

administrative professionals nationwide.

MHM provides cost savings for our clients through better practices and efficiencies, including improved recruiting, pharmacy management, and clinical operations - never by compromising care. MHM is led by a team of experienced managers and clinical directors who customize our programs and services to meet the unique needs of our clients.

MHM does not view itself as a vendor, but as a partner with our client agencies.

MHM now provides services in 14 states and serves a combined population of more than 280,000 consumers.



To find out more about MHM and our services, visit our website at www.mhm-services.com

MHM Services, Inc. 1593 Spring Hill Rd Suite 600, Vienna, VA 22182 P: 800.416.3649



THE FORENSIC MENTAL HEALTH ASSOCIATION OF CALIFORNIA

BOARD OF DIRECTORS

President

Munir Sewani, PhD

Director of Conference

Jane Lovelle, LCSW, MPH

Vice President

Sam Knudsen, Esq

Director of Education

Jeff Elias, Esq

Treasurer

Kevin Rice, LCSW

Secretary

Cynthia Lermond, PsyD

CONFERENCE PLANNING COMMITTEE

Chair

Jane Lovelle, LCSW, MPH

Members

Cynthia Borges-O'Dell

Jeff Elias, Esq

CME Chair

Anthony Cozzolino, MD

Captain Michele Fisher

James Rokop, PhD

Gina Scanlon, LCSW

MEMBERSHIP COMMITTEE

Chair

Kevin Rice, LCSW

Members

Nicole Paglione, PsyD

NEWSLETTER COMMITTEE

Chair

Cynthia Lermond, PsyD

Members

Thomas Granucci, LCSW

Anna Kafka, PsyD

Kelly Ross, LCSW

PUBLIC POLICY COMMITTEE

Chair

Sam Knudsen, Esq

Members

Positions Open

EXECUTIVE DIRECTOR

ADMINISTRATIVE ASSISTANT

Molly Willenbring

Renee Sevilla

665 Third Street, Suite 516 · San Francisco, California 94107-1618

Phone: 415.407.1344 · Fax: 415.358.4757

www.fmhac.net · fmhac@fmhac.net

FIRST FLOOR



SECOND FLOOR

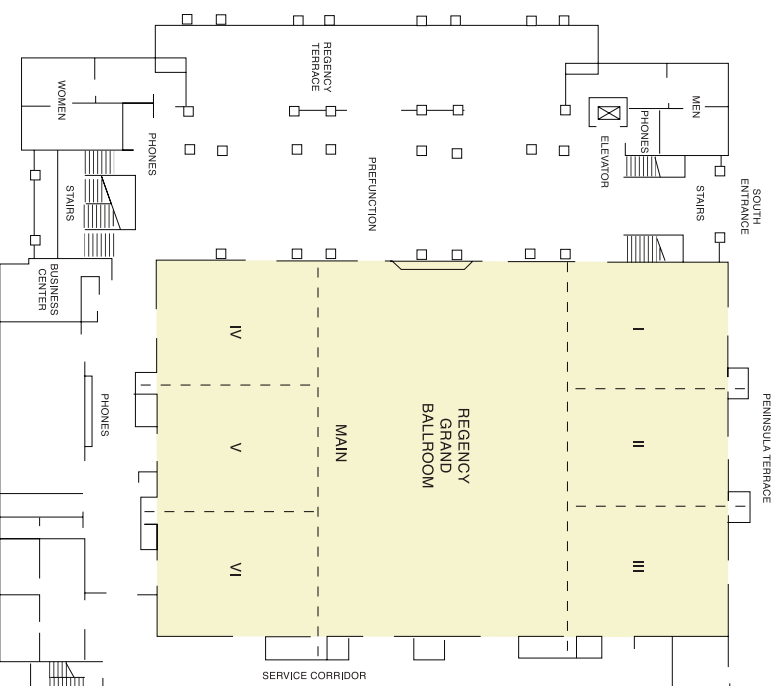

Hyatt Regency Meeting Rooms