



38th Annual Conference

FORENSIC MENTAL HEALTH ACROSS THE SPECTRUM OF THE CRIMINAL JUSTICE SYSTEM

HYATT REGENCY RESORT & SPA
MONTEREY, CA ◇ MARCH 13 - 15

THE FORENSIC MENTAL HEALTH ASSOCIATION OF CALIFORNIA

BOARD OF DIRECTORS

President

Munir Sewani, PhD

Director of Conference

Jane Lovelle, LCSW, MPH

Vice President

David Meyer, Esq

Director of Education

Kelly Ross, LCSW

Treasurer

Douglas Taylor Smith, LCSW

Secretary

Cynthia Lermond, PsyD

CONFERENCE PLANNING COMMITTEE

Chair

Jane Lovelle, LCSW, MPH

Members

Erin Alexander, Esq

Steve Barron, PhD

CME Chair

Anthony Cozzolino, MD

Joan Cairns, MFT

Shoko Kokubun, PhD

James Rokop, PhD

NEWSLETTER COMMITTEE

Chair

Cynthia Lermond, PsyD

Members

Thomas Granucci, LCSW

Anna Kafka, PsyD

PUBLIC POLICY COMMITTEE

Chair

David Meyer, Esq

Members

Mark Grabau, PhD

Peter Kalmar, MFT

Bryan Nelson, MFT

Munir Sewani, PhD

Renee Wilkinson, PhD

EXECUTIVE DIRECTOR

Molly Willenbring

665 Third Street, Suite 516 · San Francisco, California 94107-1618

Phone: 415.407.1344 · Fax: 415.358.4757

www.fmhac.net · fmhac@fmhac.net

Letter from the President

Dear Members,

Welcome to our 38th Annual Conference! Over the past 37 years, the Forensic Mental Health Association has provided an avenue for its members and conference attendees to share knowledge and experience with the goal of enhancing forensic mental health services throughout California. Upholding this tradition, our Conference Planning Committee has developed an informative and innovative program for you this year with a slate of presenters from diverse backgrounds to provide you with a valuable educational experience at our new, beautiful location.

I am especially proud to inform you of the strides the FMHAC Board of Directors has made since our last conference in pursuit of our mission and in providing more value to our membership. In January, FMHAC presented our first One Day Training on competency to stand trial and it was a great success. With support from the California State Association of Counties, FMHAC also presented the First Annual Words to Deeds Paradigm Awards, recognizing leaders who Champion forensic mental health.

It is by these efforts that FMHAC continues to work on your behalf; to improve the services and treatment of the mentally ill in the criminal justice system, to provide education, and to increase the professionalism of individuals who, like you, have chosen to dedicate your time and talent to this population.

I look forward to continuing my work with the Board and with you in making our Association a prime medium for achieving our mission - to enhance mental health services for the mentally ill in the criminal justice system and to provide opportunities for all of us to Champion effective interventions, access to treatment, risk management and reintegration of our clients into our communities.

So, as you take in the beauty of Monterey and a wealth of knowledge this week, have fun as you learn, foster your old relationships with colleagues, and take this opportunity to develop new ones.

With Best Regards,



Munir A. Sewani, PhD

FMHAC President

REMINDERS

- Complete your conference evaluation form, even if you are not seeking CEUs.
- Fill out the college registration form! They are submitted to the State of California who then provides funding for FMHAC, aiding us in providing the conference each year. It's an easy way for you to support FMHAC!
- Attendance certificates are included in your packet. Please review the requirements for continuing education units on page 13.
- Wear your name badges throughout the conference. This will be your entrance pass to all workshops and social events. Lost badges can be replaced at the FMHAC registration table.
- Check out time at the Hyatt is 12:00 noon.

PRESENTER SPOTLIGHT

Richard Walter **Co-Founder, Vidocq Society**

After more than 22 years as a Prison Psychologist with the Michigan Department of Corrections, Richard Walter now works closely with police departments and consultants on current and cold cases. An international expert on Crime Assessment, Profiling and Risk Evaluation, Mr. Walter has consulted with agencies and governments around the world. He lectures to law enforcement and academic groups on murder sub-types and signature aspects of interpersonal and workplace violence. His work in risk assessment assists corporations, police, and victims in determining appropriate safeguards for offenders, including juvenile and adult probation and parole readiness. He is the author and co-author of published and non-published articles relating to forensic casework as well as a co-founder of The Vidocq Society, an international group of 82 forensic specialists who assist local criminal justice agencies in solving cold cases.

Mr. Walter is our Keynote Presenter, speaking on ***The Mystery Clue in Searching for Jack-the-Ripper***. Read more about him in Presenter Biographies.

TABLE OF CONTENTS

WEDNESDAY

11:00 am	Council on Mentally Ill Offenders	1
	Open Meeting	
12:30 am	Registration	1
1:30 pm	Opening Session	1
	• Kent Kiehl, PhD	
7:00 pm	Welcome Presentation	1
	• Student Scholarship Winners	
	• COMIO Best Practices Awards	
	• FMHAC Christine M. West Awards	
	Keynote	2
	• Richard Walter, Co-Founder of the Vidocq Society	
9:00 pm	Welcome Reception	2
	Poster Presentations	

THURSDAY

	Morning Workshops	3
	Afternoon Workshops	7
5:00 pm	Annual FMHAC Business Meeting	10
	• Board of Directors Elections	

FRIDAY

8:30 am	Wrap Up Sessions	11
	• James Cantor, PhD	
	• David Naimark, MD	
	• William Newman, MD	
	Continuing Education Information	12
	Meeting Room Floorplan	back



11:00 am
Spyglass 1

STATE COUNCIL ON MENTALLY ILL OFFENDERS OPEN MEETING

12:30 - 6:00pm
Meeting Room
Building

REGISTRATION

FMHAC MERCHANDISE FOR SALE!

1:30 - 5:00 pm
Regency Ballroom

OPENING SESSION (3.0 CE hrs)

CEU
CPA
MCLE*
CME*
POST*

Contemporary Issues in the Assessment of Sex Offenders: Discussions on The Science of Psychopaths: Assessment, Recidivism, Neuroscience & Treatment

Kent A. Kiehl, PhD, Consultant, University of New Mexico

Psychopathy has emerged as one of the most important constructs for the legal system. Psychopaths present with special management challenges when institutionalized and they are more likely than nonpsychopaths to relapse to crime and substance abuse upon release from prison. Estimates suggest that as much as 50% of violent crime in North America is committed by individuals who meet criteria for psychopathy. Recent advances in neuroscience has led to a much greater understanding of the neural abnormalities that characterize the condition. There have even been advances in treatment that have identified substantial reductions in recidivism and other outcome variables. This seminar will review the modern assessment of psychopathy, the role the condition plays in recidivism, the latest neuroscience, aspects for treatment and management of the condition, and how the neuroscience data is impacting the legal arena.

7:00 pm
Regency Ballroom

WELCOME AND INTRODUCTIONS

Munir Sewani, PhD, President, Forensic Mental Health Association of California

- State Council on Mentally Ill Offenders
2013 Best Practices Awards
- Forensic Mental Health Association Annual Awards
Christine M. West Award for significant individual
contributions in areas of forensic mental health

*MCLE and POST credits are under review for selected sessions. CME credits are pending for selected sessions. Contact FMHAC after the conference for an update.

(Welcome presentation continued)

CEU
CPA

KEYNOTE ADDRESS (1.5 CE hrs)

The Mystery Clue in Searching for Jack-the-Ripper

Richard Walter, Co-Founder, The Vidocq Society

In 1888, Londoners hosted, within only 90 days, what would come to be the most infamous and purported enigmatic sex-murder case of the century called “Jack-The-Ripper.” Although a myriad of theories and suspects were considered, the violent crimes abruptly stopped on their own without continuance of any similar psychopathology elsewhere in the world. Purveyors of conspiratorial theories abounded with glee to include the Queen’s physician (old and overweight), Prince Albert, Duke of Clarence (a sexual Disneyland), Jews, a leather-aproned butcher and many others as possible suspects. And, these crimes were considered sexual offenses...without any direct sexual contact with any of the 6 the prostitute victims. Why?

With modern developments in Crime Assessment, this presentation will review photographs and facts to examine the pattern of these crimes. In some instances, we will find anomalies in the patterns that have been thought to be absolutely true. When examined forensically, we will find the offender had secrets, failures, privilege, jealousy, hatred and a foreboding sense of hurt and ironic doom. Following presentation of known information, forensic schemes and primary suspect’s, attendees will be invited to confirm or deny the descriptor of “Sexual Sadism”.

9:00 pm

FMHAC WELCOME RECEPTION

POSTER PRESENTATIONS



ABOUT THE FMHAC CHRISTINE M. WEST AWARD

Christine M. West was Director of San Francisco Jail Psychiatric Services for eight years and helped establish Forensic Health Care, Inc. Her dedication to the field included an enormous investment of energy in the Forensic Mental Health Association of California, including service as the Board Treasurer and on numerous committees. Ms. West spoke nationally about jail forensic mental health issues before she passed away in late 1991.

BREAK OUT SESSIONS

8:30 - 10:00 am (1.5 CE hrs)

1. Cypress

CEU

CPA

MCLE*

CME*

Preparing for the Century of Aging: What You Should Know about the Epidemiology and Health of Older adults in the Criminal Justice System

Brie Williams, MD, MS, Division of Geriatrics, UCSF

At the root of a healthcare crisis in the U.S. criminal justice system that is spilling into communities and public healthcare systems, the criminal justice population is aging at an even more rapid rate than the US population. Older prisoners, on average, have early onset chronic medical conditions, untreated mental illness, and unmet psychosocial needs. Following release, older former prisoners present the least risk of re-incarceration yet prove particularly vulnerable to profound social and medical challenges, such as homelessness, poor employability, multiple chronic medical conditions, and high mortality risk. As a result, emergency healthcare and hospitalization are commonplace among former prisoners. Increasingly, criminal justice institutes, policymakers and the media view the growing older prisoner population as a health and economic crisis for both the criminal justice system and for communities. Yet, more resources and attention are needed to effectively meet the mental and physical healthcare needs of the growing number of incarcerated and formerly incarcerated adults in the U.S.

2. Ballroom I/II/III

CEU

CPA

MCLE*

CME*

POST*

PART 1 How Was It For You? A Discussion of a Year's Experience with AB 109 and Mentally Ill Prisoner Reentry

Moderators:

Honorable Judge Steven Manley, Santa Clara Superior Court

David Meyer, Esq, USC Institute of Psychiatry, Law, & Behavioral Science

Panelists:

Chief Mack Jenkins, San Diego County Probation Department

Mary Marx, LCSW, Mental Health Clinical District Chief, LA County

Sheriff Ross Mirkarimi, San Francisco Sheriff's Department

Darby Kernan, Policy Consultant. Senator Darrell Steinberg

Brenda Grealish, Deputy Director, Office of Research, CDCR

Anne Robin, MFT, Director of Behavioral Health, Butte County

Kimberly D. Bushard, Field Representative, Board of State and Community Corrections

AB 109 has significantly changed the structure and relationship of state and local corrections as well as mental health services for both adult and juvenile offenders in California. This panel has been designed to highlight what is working, where the problem areas are, and to stimulate discussion that can lead to further clarification, work, and/or policy development. The State Council On Mentally Ill Offenders and the Forensic Mental Health Association of California are pleased to provide this opportunity to highlight the positive and examine problematic issues that require attention while working for improved services and outcomes.

Meeting Room map on back cover

3. Spyglass

CEU
CPA
CME*

Penile Plethysmograph

Wesley Maram, PhD, President, Clinical Director, Maram Psychological Group, Inc.

Although the Penile Plethysmograph (PPG) has been around since the 1940's, it remains the "Gold Standard" of measurement of deviant sexual arousal. This lecture will briefly overview the history and supporting research, the court ruling on its admissibility and its treatment application. The discussion will include a description of the various stimulus presentations used with the PPG for different population, and interpretative strategies, followed by a live demonstration of PPG instrumentation.

4. Big Sur

CEU
CPA
CME*

Re-Conceptualizing Therapeutic Communities in Secure Forensic Settings

Raymond Scott, PhD, Psychologist, Atascadero State Hospital

Given the range of changes over the past half century to the standard Therapeutic Community (TC) model, many policy makers and clinicians question whether its underlying cultural, structural, and programmatic traditions characteristic have been lost as well as the empirically documented effectiveness of this treatment modality. Even as new treatment technologies have emerged, however, studies have consistently shown the TC model to be an effective form of treatment. This presentation will compare and contrast the standard and modified therapeutic community (MTC) models, discuss how the adoption of managed care techniques have impacted the treatment process in TCs, and discuss the empirical research that supports the effectiveness of milieu therapy in MTCs.

5. Ballroom IV/V/VI

CEU
CPA
MCLE*
CME*

PART 1 Evaluating Juveniles' Competence to Stand Trial: Methods, Emerging Standards, and Controversies

Kimberly Larson, PhD, JD, Assistant Professor, Law and Psychiatry Program and the Center for Mental Health Services Research, University of Massachusetts Medical School

Like most states, California's courts, juvenile attorneys, and clinicians have struggled during the past decade with the relatively new demands of competence to stand trial (CST) as a defendant's right in juvenile courts. In recent years, new research, methods and guidance have been provided to address these demands. After defining CST and its basic concepts, the first session (PART 1) of this three-hour workshop describes recent peer-reviewed research in forensic developmental psychology to assist lawyers and clinicians in addressing juveniles' competence as trial defendants. Emphasis is placed on ways in which adolescents' capacities relevant for CST are different from those of adults. The second session (PART 2) focuses on best practices and evolving standards in performing evaluations of juveniles' CST, with emphasis on how these practices are different from adult CST evaluations. Finally, an empirically-based model is offered for making judgments about the difficult area question of remediation (restoration) of incompetence in juveniles.

*MCLE and POST credits are under review for selected sessions. CME credits are pending for selected sessions. Contact FMHAC after the conference for an update.

10:00 am **COFFEE BREAK**

10:30 - Noon (1.5 CE hrs)

1. **Cypress** **Update on the Misuse of Psychiatric Medications in Correctional Settings**
CEU
CPA Anthony Cozzolino, MD, Chief Psychiatrist, Adult Division, Department of
CME* Mental Health, Santa Clara Valley Medical Center
POST* Douglas Del Paggio, PharmD, MPA, Director of Pharmacy Services, Alameda
County Behavioral Health Care Services

This presentation will help define the appropriate use, misuse, and abuse of psychotropic medications for non-prescribing mental health clinicians in forensic work settings. It will include the current FDA-approved indications, and most common clinical uses of specific psychotropic medications, most frequently encountered in forensic settings and attendees will gain an understanding of the scope and magnitude of the problem of misuse of psychotropic medications. Recent literature regarding the demographics, prevalence, and costs of abuse of psychotropic medications will be presented. Presenters will discuss recent outcomes research, regulations, and potential solutions to identify and mitigate misuse and diversion of medications in forensic settings.

This presentation will include a review of clinical terminology and definitions commonly found in the literature on the topic of misuse of psychotropic medications; the history of FDA and DEA labels, designations, and regulations; and specific profiles and clinical characteristics of medications, which increase the potential for misuse/abuse, and the variations across clinical settings.

2. **Ballroom** **PART 2 How Was It For You? A Discussion of a Year's Experience**
I/II/III **with AB 109 and Mentally Ill Prisoner Reentry**
CEU
CPA Moderators:
MCLE* Honorable Judge Steven Manley, Santa Clara Superior Court
CME* David Meyer, Esq, USC Institute of Psychiatry, Law, & Behavioral Science
POST* Panelists:
Chief Mack Jenkins, San Diego County Probation Department
Mary Marx, LCSW, Mental Health Clinical District Chief, LA County
Sheriff Ross Mirkarimi, San Francisco Sheriff's Department
Darby Kernan, Policy Consultant. Senator Darrell Steinberg
Brenda Grealish, Deputy Director, Office of Research, CDCR
Anne Robin, MFT, Director of Behavioral Health, Butte County
Kimberly D. Bushard, Field Representative, Board of State and Community
Corrections

AB 109 has significantly changed the structure and relationship of state and local corrections as well as mental health services for both adult and juvenile offenders in California. This panel has been designed to highlight what is working, where the problem areas are, and to stimulate discussion that can lead to further clarification, work, and/or policy development. The State Council On Mentally Ill Offenders and the Forensic Mental Health Association of California are pleased to provide this opportunity to highlight the positive and examine problematic issues that require attention while working for improved services and outcomes.

Meeting Room map on back cover

3. Spyglass Sexual Recidivism and Use of the Containment Model in California

CEU

CPA

MCLE*

Janet Neeley, Esq, Deputy Attorney General, Office of the Attorney General
Jack Wallace, LCSW, Coordinator, California Sex Offender Management Board,
California Department of Corrections and Rehabilitation

Alyson Lunetta, MS, California Department of Justice Sex Offender Tracking
Program, California Department of Corrections and Rehabilitation

This panel will discuss the Containment Model currently being used in California for sex offenders on probation or parole, including the role of various types of risk assessment. Practical and legal aspects of the law's requirements will be reviewed. The panel will also discuss current issues in sex offender risk assessment in California from the perspective of the state risk assessment (SARATSO) Committee, as well the release of 5-year recidivism statistics from a California sex offender recidivism study sponsored by SARATSO and the California Department of Justice.

4. Big Sur Mass Murder in America

CEU

CPA

Eric Woodard, MD, Associate Professor of Psychiatry, University of California,
San Francisco

The term "mass homicide" was only coined in the middle of the 20th century. Is it a new phenomenon? If so, what is different, and why is it happening now? There seems to be a new mass shooting every other week - has this always been the case? In 1989, The Washington Post proclaimed "mass murder has seized the workplace with unprecedented fury," and USA Today noted that workplace violence was on the upswing and the stories "continue at hundreds per year." But "going postal" is about as new as the postal service. Why do we feel like this is an epidemic?

What about the perpetrators? Have they just been pushed too far and "snapped"? Are they loners, the disenchanteds? Were they bullied too much as children? Are they mostly schizophrenics, or the mentally unstable? Or are they psychopaths, who have carefully planned acts of revenge against the world that wronged them, and often warn many people that they are about to kill?

What about the horrific school shootings? The massacre at Sandy Hook Elementary school earlier this year was unprecedented in its depravity, carnage and death toll. Or was it? In this presentation I will attempt to put a historical perspective on mass murder and tease out what are legitimate concerns, and what happen to be waves of sporadic, infrequent, violent occurrences in our national history.

5. Ballroom PART 2 Evaluating Juveniles' Competence to Stand Trial: Methods, IV/V/VI Emerging Standards, and Controversies

CEU

CPA

MCLE*

CME*

Kimberly Larson, PhD, JD, Assistant Professor, Law and Psychiatry Program and
the Center for Mental Health Services Research, University of Massachusetts
Medical School

See description on Page 4.

*MCLE and POST credits are under review for selected sessions. CME credits are pending for selected sessions. Contact FMHAC after the conference for an update.

12:00 noon LUNCH BREAK

1:30 - 3:00 pm (1.5 CE hrs)

1. Cypress Jail-Based Competency-Restoration: Findings from Liberty Healthcare's 2-year Restoration of Competency (ROC) Pilot Program

CEU

CPA

MCLE*

CME*

POST*

Kevin Rice, LCSW, Executive Director, Restoration of Competency Program

Lisa Hazelwood, PhD, Forensic Psychologist

Terry Fillman RN, MBA, CCHP, Health Services Administrator, San Bernardino County Sheriff's Department

Are jail-based competency-restoration programs a viable alternative to traditional state hospital-based treatment? This presentation reviews two years' worth of outcome data from the Liberty Healthcare Restoration of Competency (ROC) pilot program launched in January 2011 in San Bernardino County. Program efficacy, treatment innovations, unexpected outcomes, and fiscal implications are discussed. Special attention is given to the program's impact on malingering and how jail-based restoration assessment/treatment differs from traditional state hospital treatment. Case studies are presented.

2. Ballroom A Lawyer's Perspective On Mental Retardation/Intellectual Disability Assessments In Capital And Non-Capital Cases

I/II/III

CEU

CPA

MCLE*

John Philipsborn, Esq. M.Ed., Law Offices of John T. Philipsborn

In California, and elsewhere (including in the Federal court system), intellectual disabilities amounting to what the law defines as 'mental retardation' may allow diversion out of the criminal court system; a partial or complete state of mind defense; or a legally valid exclusion from the death penalty. The definitions of mental retardation, and methodologies for assessing intellectual disabilities have been reviewed in a number of litigations. This presentation will review some of the published cases on the topic, together with literature that has been relied on by courts, experts, and lawyers, in approaching the subject matter.

THANK YOU

2013 SUSTAINING MEMBERS

OF THE FORENSIC MENTAL HEALTH
ASSOCIATION OF CALIFORNIA

Gil Abdalian, MFT

Tom Beem, LPT

Kenneth Carabello, LCSW

Carson Chambers, PhD

Diana Concannon

Harry Goldberg, PhD

Mark Grabau, PhD

Laurie Hughes, PhD

Ronald Kaufman, PsyD

Cynthia Lermond, PsyD

Joseph Lockhart, PhD

David Meyer, Esq

Bryan Nelson, MFT

Kelly Ross, LCSW

Neil Ross, MA

John Schipper, PhD

Munir Sewani, PhD, MFT

Douglas Taylor Smith, LCSW

Meeting Room map on back cover

3. Spyglass

CEU

CPA

MCLE*

CME*

POST*

Adolescent Sex Offenders: An Overview

James Rokop, PhD, Clinical Psychologist

The label 'adolescent sex offender' denotes a well-defined taxonomy that is in fact, misleading. Adolescent sex offenders tend to be more similar to other adolescent offenders and sexual offending typically only forms one aspect of a more varied criminal pattern. Formal assessment is critical for understanding and treating the adolescent sex offender and specialized sex offender treatment appears effective in lowering risk (for both sexual and nonsexual offenses) even after long-term follow-up. Finally, risk assessment with adolescent sex offenders has evolved over time but still lacks refinement, empirical support, and the ability to make precise probabilistic estimates of sexual and nonsexual recidivism. This presentation will discuss these aspects of adolescent sex offender work and more.

4. Big Sur

CEU

CPA

Evolution of a Forensic System: From Safety to Sacramento

Katherine Warburton, DO, Deputy Director of Clinical Operations, Acting Medical Director, California Department of State Hospitals

Barbara E. McDermott, PhD, Professor of Clinical Psychiatry, Division of Psychiatry and the Law, UC Davis School of Medicine

Kathy Gaither, Chief Deputy Director, Department of State Hospitals

In this presentation, Dr. McDermott will discuss her research into the types and severity of inpatient aggression at Napa State Hospital, as well as the predictive value of standardized risk assessments in this population. Dr. Warburton will discuss the multi-factorial clinical and systemic issues that contribute to aggression in a large forensic mental health population. Ms. Gaither will discuss the political and administrative challenges of reducing aggression while transitioning a large state mental health department.

5. Ballroom

IV/V/VI

CEU

CPA

MCLE*

Juvenile Mental Health Court: One County's Experience

Honorable Allan Hardcastle, Juvenile Division, Sonoma County Superior Court

Larry Younger, Deputy Probation Officer, Sonoma County Probation Department

Ariel Spindell, MS, LMFT, Program Director, Sunny Hills Services

Robert Ochs, LCSW, Chief Probation Officer, Sonoma County Probation Department

Michael Kennedy, LCSW, Director of Behavioral Health, Sonoma County Department of Health Services

This panel presentation will discuss Sonoma County's experience establishing and conducting a Juvenile Mental Health Court. This court is multi-disciplinary, and panel members will include key stakeholders, including the Juvenile Court Judge, Mental Health Director, Probation, and the community-based organization providing services. Further, videos will include comments from a Juvenile Public Defender and District Attorney, and youth who have successfully completed the program.

*MCLE and POST credits are under review for selected sessions. CME credits are pending for selected sessions. Contact FMHAC after the conference for an update.

Meeting Room map on back cover

3:00 pm COFFEE BREAK

3:30 - 5:00 pm (1.5 CE hrs)

- 1. Cypress**
CEU
CPA
MCLE*
POST*

Beyond Delinquency: Specialized Housing and Services for Youth in Detention

Mary Romero, LCSW, Clinical Program Head, Central Juvenile Hall, Los Angeles County Department of Mental Health

Michael Arrington, Deputy Probation Officer, Individual Behavior Management Program (IBMP) Coordinator, Central Juvenile Hall

Erica Reynoso, PhD, LCSW, Clinical Psychologist, Juvenile Justice Division

An increasing number of detained youth with special needs pose housing and treatment challenges for juvenile justice professionals. At Central Juvenile Hall in Los Angeles, collaborative efforts by County partners have accomplished a shared mission to provide youth with appropriate housing and adjunct services during their period of detention. Probation and Mental Health panelists will provide an overview of these Specialized Housing Units and will discuss outcomes, obstacles and the continued need for these programs.
- 2. Ballroom I/II/III**
CEU
CPA
MCLE*
CME*
POST*

Understanding And Applying The Legal Gateway Standards For The Admission Of Mental Health Expertise In State And Federal Criminal Cases (NOTE: this session ends at 4:45pm, 1.25 CEs)

John Philipsborn, Esq, M.Ed., Law Offices of John T. Philipsborn

This presentation will review the case law that defines the legal ‘gateway’ tests for the admission of mental health expertise in criminal cases, covering the California and Federal standards, and will include suggestions on how mental health professionals can be suitably prepared to address questions about their qualifications, and about the relevance and reliability of their work in a given case in view of the sorts of questions that have arisen in a variety of litigations in which the exclusion of mental health experts’ opinions has been sought.
- 3. Spyglass**
CEU
CPA
CME*

Applying the Risk, Needs, & Responsivity Principles to Sex Offender Treatment

Gerry Blasingame, PsyD

This brief presentation introduces the evidence based human service principles of risk, needs, and responsivity (RNR) as applied to treatment and management of sexual offenders and other criminals. Specific tools that are required by the State Approved Risk Assessment Tools for Sexual Offenders (SARATSO) Committee for use with registered sexual offenders will be discussed in the RNR context.

*MCLE and POST credits are under review for selected sessions. CME credits are pending for selected sessions. Contact FMHAC after the conference for an update.

4. Big Sur
CEU
CPA
CME*
MCLE*
POST*

Neuropsychological Deficits Associated with Mild Traumatic Brain Injury of Veterans Recently Discharged from OEF/OIF

K. Drorit Gaines, PhD, Mental Health Specialist, Researcher, Veterans Affairs of Greater Los Angeles

In mild Traumatic Brain Injury (TBI), functions served by the prefrontal cortex are often disrupted. This presentation will cover research findings of neuropsychological testing of veterans diagnosed with mild TBI based on a Veterans Affairs study with recent veterans of the OIF/OEF. Executive dysfunction, the presence of depressive symptoms, level of effort, compromised self-awareness, and pharmacological treatment will be discussed, along with potential implications on behavior, emotional regulation, and rehabilitation.

5. Ballroom
IV/V/VI
CEU
CPA
MCLE*
CME*

Conduct Disorder: What is this Anyway?

Jeffrey Rowe, MD, Clinical Director, Child and Adolescent Psychiatry, Rady Children's Hospital-San Diego and UCSD

There has been much discussion about whether "Conduct Disorder" is really an illness. Recent literature over the past 5 years has begun to find real neuroanatomical and neurophysiological differences in some of the children and youth labeled with this disorder. It is also true that many of the children and youth with this diagnosis do not have the measurable findings; why is this? This presentation will explain why "Conduct Disorder" has been so hard to study, treat, and understand and will offer recommendations for how to approach and assist children and youth with this diagnostic label.

5:00 pm
Ballroom
IV/V/VI



ANNUAL FMHAC BUSINESS MEETING
All conference participants are encouraged to attend.

GET MORE INVOLVED IN FMHAC!

5:00 PM ANNUAL FMHAC BUSINESS MEETING BALLROOM IV/V/VI

Help FMHAC thrive by participating in the annual business meeting! Non-members are encouraged to attend but only current members may vote.

Board of Directors Vacancies

- President-Elect
- Vice President
- Treasurer

Room check out at the Hyatt is 12:00 noon.

Track A

8:30am-3pm	Pedophilia and Brain Research: From the Basics to the State-of-the-Art
Ballroom I/II/III	James Cantor, PhD, Senior Scientist, Centre for Addiction and Mental Health
CEU	This session is aimed at professionals with little or no background in brain anatomy or neuroscience. It will help attendees understand how the brain processes sexual stimuli, how MRI is used to study pedophilia, and the current body of MRI findings about pedophiles and offenders against children. This training will make the current literature more accessible, and help forensic professionals to critically evaluate the claims made about the potential implications of this research.
CPA	
MCLE*	
CME*	
POST*	
Break at 10am	
Lunch at 12 noon	

Track B

8:30 -10 am	Forensic Geropsychiatry: Legal and Treatment Issues
Ballroom IV/V/VI	David Naimark, MD, Clinical Professor of Psychiatry, University of California, San Diego
CEU	As the general population ages, so too does the population of the incarcerated. Elderly inmates present special challenges, in both their physical status and their cognitive status. In this presentation, Dr. Naimark will address the legal and ethical issues associated with the management of the elderly inmate. In particular, he will focus on the issues of the analysis of mental capacity, voluntariness, and informed consent. He will also look specifically at the appropriate use of the Due Process in Competency Determinations Act in the elderly inmate.
CPA	
MCLE*	
CME*	
POST*	
10:00 am	COFFEE BREAK
10:30 - 12 noon	Assessment and Management of Aggression
Ballroom IV/V/VI	William Newman, MD, Assistant Professor of Psychiatry & Behavioral Sciences, University of California, Davis
CEU	Dr. Newman will discuss techniques for assessing the risk of aggression in individual patients. He will then present existing evidence relevant to short-term and long-term management of aggression. Characterizing the type(s) of aggression primarily displayed by patients and tailoring the interventions accordingly can help make treatment settings safer environments for patients and staff alike. Finally, Dr. Newman will walk participants through case vignettes and lead a discussion about appropriate management strategies.
CPA	
CME*	
POST*	

*MCLE and POST credits are under review for selected sessions. CME credits are pending for selected sessions. Contact FMHAC after the conference for an update.

CONTINUING EDUCATION

Find your licence type below and follow the instructions to receive CE credit. It is recommended that you use the Sign In/Out form provided in your folder to ensure FMHAC has a record of your session attendance.

Don't forget to be signed in and out of your sessions. DO NOT ask FMHAC to sign for a session outside the meeting room of that class, after a class has started, or before a class has ended. We can't put our CE providership in jeopardy!

CEU - All Workshops Approved

BBS/BRN (MFT, LCSW, RN, NP, LVN, Psych Tech)
BBS provider #PCE 4800, BRN provider #CEP 5965
Fill out the FMHAC Evaluation Form to receive credit.
We recommend you utilize the Sign In/Out form.

CPA (Psychologists) - All Workshops Approved

CPA OPD provider #FOR005
Complete the following forms and turn them in at the registration table at the end of the conference to receive credit.

1. Sign In/Out form (duplicate form). One form is provided to each attendee for the entire conference. Make sure to obtain FMHAC initials at each workshop you attend and that a member of the FMHAC Board signs the form at the end of the conference. Maintain your yellow copy.
2. CPA/CME-SPECIFIC Evaluation form is required. It will be sent to you after the conference.

MCLE - See Courses Marked MCLE*

*MCLE credits are under review. Contact FMHAC after the conference for an update.
Fill out the FMHAC Evaluation Form to receive credit.
We recommend you utilize the Sign In/Out form.

POST - See Courses Marked POST*

*POST credits are under review. Contact FMHAC after the conference for an update.
Sign the POST attendance sheet at each session to receive credit.

STC - Special Certification

Apply for Special Certification through your STC training manager/coordinator.

CME - See Courses Marked CME*

*CME credits are pending. Contact FMHAC after the conference for an update.
Complete the following forms and turn them in at the registration table at the end of the conference to receive credit.

1. Sign In/Out form (duplicate form). One form is provided to each attendee for the entire conference. Make sure to obtain FMHAC initials at each workshop you attend and that a member of the FMHAC Board signs the form at the end of the conference. Maintain your yellow copy.
2. CPA/CME-SPECIFIC Evaluation form is required. It will be sent to you after the conference.

Join the Conversation

LillyPAD

CONQUERING 21ST CENTURY HEALTH CARE CHALLENGES REQUIRES A 21ST CENTURY DIALOGUE

Eli Lilly and Company launched LillyPad — a public policy blog and Twitter feed — to begin a dialogue on how to address critical health care issues that affect us all. We want to bring the most innovative views to the foreground so we can work together to determine how to best bring the next generation of lifesaving medicines to patients.

Come to LillyPad.Lilly.Com or follow us on Twitter @LillyPad to share your thoughts and perspectives.

The Lilly logo, featuring the word "Lilly" in a red, cursive script font.

GOLD CORPORATE MEMBER



SUNOVION

SILVER CORPORATE MEMBERS



PAR products can help you assess child abuse, malingering, response style, offender responsibility, competency to stand trial, and more...



Stop by the PAR booth to learn about our products.

Receive 10% off plus free domestic ground shipping on all orders placed during the conference.

Creating Connections. Changing Lives. **PAR** • 1.800.331.8378 • www.parinc.com

FIRST FLOOR



SECOND FLOOR

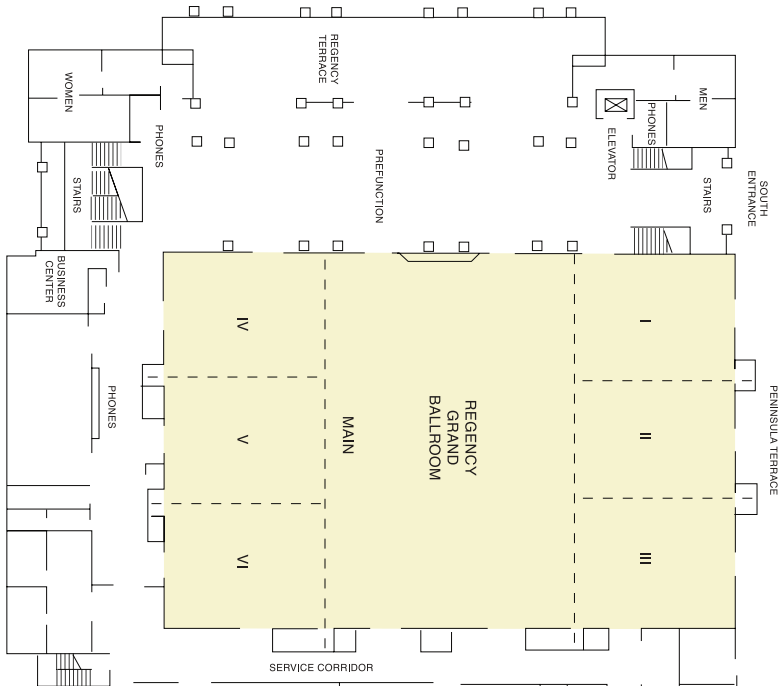

Hyatt Regency Resort & Spa Meeting Rooms